

Exploro® Highly Sensitive THC URINE TEST For Home Use (50 ng/ml)

After consumption of any products containing THC: marijuana, cannabis edibles, THC vape juice and other products containing THC

The **Exploro® Highly Sensitive THC Urine Test** is a competitive binding, lateral flow immunochromatographic assay for the qualitative detection of THC metabolites in human urine at the cutoff concentrations of 50 ng/ml (**see FAQ #8**).

The Exploro® Highly Sensitive THC Urine Test is designed to detect THC metabolites (**see FAQ #1**) in human urine through visual interpretation of color development on the test strip.

ITEMS PROVIDED

- THC test strips (see back of the box for quantity)
- User instructions

ITEMS NOT PROVIDED

- Timer
- Urine collection container

STORAGE

- Store the test at 39-86 °F (4-30 °C). DO NOT FREEZE.
- Do not open the pouch until ready for use.

DETECTION LEVEL AND APPROXIMATE DETECTION TIMES

- Detectable level: 50 ng/ml
- Minimum detection time*: 2 hours
- Maximum detection time*: 35+ days¹

* **Note:** The time indications are only approximate.

⚠ WARNING

- Read the complete information before performing the test.
- This assay provides only a preliminary analytical test result. A more specific alternate chemical method must be used to obtain a confirmed analytical result. Gas chromatography/mass spectrometry (GC/MS) or Liquid chromatography-tandem mass spectrometry (LC-MS/MS) are the preferred confirmatory methods. Clinical consideration and professional judgment should be applied to any drug of abuse test result, particularly when preliminary positive results are indicated.
- Have a watch, clock, or timer available.
- Do not use the test after the expiration date printed on the package and foil pouch.
- Do not use the test if its foil pouch is torn or damaged.
- The test is for one-time use only, do not reuse the test.
- Certain foods or medications may affect test results (**see FAQ #6**).
- Contaminated, tainted or diluted urine sample may affect test results (**see FAQ #14**).
- If you suspect that the urine sample may have been tampered with, a new urine sample should be collected.
- Keep out of reach of children.

TESTING

Before you begin

- Allow the test to reach room temperature before testing.
- Prepare a watch, clock, or timer.
- Prepare a urine collection container.

Step 1

- Collect urine in the urine collection container (**see FAQ #5**).
- Remove the test strip from the sealed pouch and use it immediately (**see FAQ #10**).

Note: Prolonged exposure to hot and humid environments will cause product deterioration. Do not use the test after the expiration date (**see FAQ #12**).

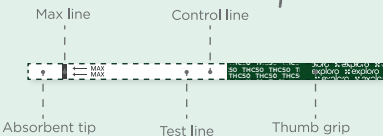
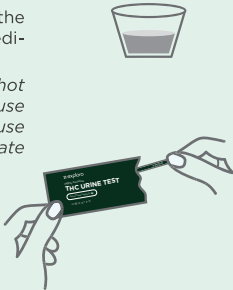

Step 2

- With arrows pointing toward the urine sample, immerse the test strip vertically in the urine for 10-15 seconds. Do not pass the maximum line ("MAX") on the test strip when immersing it.
- Place the test strip on a non-absorbent flat surface. It is convenient to use the back side of the test strip pouch for this purpose.
- Start the timer immediately after urine application.

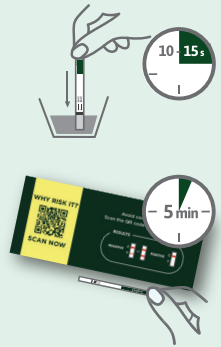

Step 3

Read the test results exactly in 5 minutes. Do NOT read them after 5 minutes (**see FAQ #4**).

Note: Do not read the test results after 5 or more minutes after immersing the test strip. The chemical reaction will not provide accurate results anymore.

RESULTS

Read the results by visual comparison (**see FAQ #6**).

NEGATIVE



Two lines appear. One red line marks the Control (C) region, another line (red or pink) adjacent to the first line marks the Test (T) region. This negative result indicates that the concentration of THC metabolites is below the detectable level (50 ng/ml).

Note: The shade of the red line in the Test (T) region may vary, but it should be considered negative whenever there is even a faint pink line (**see FAQ #7**).

POSITIVE



Only one colored line appears in the Control (C) region. No visible colored line appears in the Test (T) region. This positive result means that THC metabolites are found in your urine and their concentration is above the detectable level (50 ng/ml).

Note: It is recommended that any urine sample with a preliminary positive result be sent to a certified laboratory for confirmatory testing (**see FAQ #6, 8, 9**).

INVALID



The line in the Control (C) region fails to appear (the line in the Test (T) region might or might not appear). Results from any test that has not produced a line in the Control (C) region at the specified result reading time must be discarded. Please review the procedure and repeat with a new test strip.

If the problem repeats, discontinue using the kit immediately and contact us at hello@exploroproducts.com.

**Worried about your THC test?
Scan the QR code for exclusive
expert guidance!**



exploro.us/thc-guide

FREQUENTLY ASKED QUESTIONS

1. What are THC metabolites?

THC is rapidly broken down and modified into molecules known as metabolites. At least 80 different metabolites are formed from THC and may affect the body's endocannabinoid system. These metabolites are stored in body fat and are gradually eliminated from the body through feces and urine. The Exploro® Highly Sensitive THC Urine Test is designed to detect THC metabolites in human urine.

2. How do I know that the test has worked well?

When the line in the Control (C) region appears, it means the test strip is performing well.

3. What does the preliminary test result mean?

The Exploro® Highly Sensitive THC Urine Test is a "screening test". To obtain a confirmatory test, it is recommended to perform a laboratory test. Gas chromatography/mass spectrometry (GC/MS) and Liquid chromatography-tandem mass spectrometry (LC-MS/MS) are considered the gold standards in laboratory testing for most drugs.

4. Why is it important to read the results in precisely 5 minutes?

You should read the results in precisely 5 minutes after the test strip was immersed in a urine sample. Do not read the results after 5 or more minutes after immersing the test strip. After 5 minutes, the chemical reaction is unstable, and the line color changes on the test strip may occur.

5. When is the best time to run the test?

It is recommended to perform the tests using the first morning urine because urine concentration is highest in the morning. During the day consuming food and liquids as well as performing physical activities may influence the urine concentration thus affecting test results.

6. To what extent can I trust the test result? Are there any factors that can affect the test result?

The test result will be reliable if the test is performed in strict accordance with the instructions provided. However, certain foods and OTC medications or prescription drugs may cause a preliminary positive result.

7. How to interpret the test if the color and the intensity of the "T" and "C" lines are different (e.g. the "T" line is of a lighter color than the "C" line)?

When you see two lines (no matter how light or dark the "T" line is), it means that the result of your test is negative.

Possible reason for a light "T" line:

- **Low drug concentration.** The concentration of THC metabolites in your urine is somewhere around the test's cut-off level (see "Detection Level and Approximate Detection Times" part). When the concentration of THC metabolites in the human body is around the test's cut-off level, it is possible to see both positive and negative results within a short time. It happens because the concentration is "on edge" between being positive and negative.

- **Diluted urine sample.** If a person drinks a large amount of water or other fluids before taking a urine drug test, it can dilute the urine and lower the concentration of THC metabolites in the sample. This can cause a light "T" line to appear.

- **Time of drug use.** Depending on multiple factors, the rate at which drug metabolites appear in the urine vary from person to person.

If a person has not used the drug for a prolonged period of time and has recently consumed it (within the last few hours), the concentration of drug metabolites in their urine may still be too low to trigger a positive result. In such cases, a faint "T" line may appear, which means the test result is negative at that specific moment and only reflects the current urine sample. Since metabolite levels may still be rising in the body, it is strongly recommended to take another test using a fresh urine sample in a few hours. For the most accurate results, test again the next morning using the first morning urine, which is usually the most concentrated.

8. What does a cut-off level mean?

A cut-off level is a level that a drug must meet or exceed in urine to trigger a positive result.

With any instant urine drug test, it is important to note a negative result does not always mean the urine sample is drug-free. It may contain a drug at a concentration that is lower than the defined cut-off level. Different drugs are processed by the body at different rates. The window of detection for a drug begins to decrease over time once it has reached its highest level of concentration in the body. Factors that can affect detection time include physical body type, metabolic rate, dietary habits, dosage size, dosage method, drug purity.

Under the US Federal guidelines, THC drug testing has two cut-off levels for positive detection. Laboratories that follow the guidelines, consider drug testing to be negative if detection is below either cut-off level. In the case of urine analysis, drug testing cut-off levels are measured in nanograms per milliliter (ng/ml). For example, an initial screening for THC must show at least 50 ng/ml. Then confirmatory tests must prove at least 15 ng/ml. If the initial screening does not show at least 50 ng/ml,

A visual example of a cut-off level and window of detection after a drug has been dosed

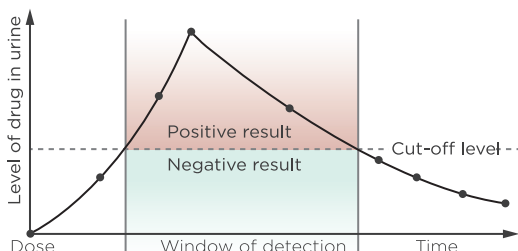

then the result is considered to be negative, and the confirmatory tests are not performed.

9. How long can THC metabolites be detected in human urine?

The window of detection of THC metabolites is highly dependent on the quality of the THC products used, the individual's body fat content and metabolism, chronicity of use, the individual's state of hydration when the urine sample is collected. THC metabolites can be detected in urine for up to 35+ days after last use.

10. I opened a pouch, but I am not going to use it right away. Can I save it for later use?

NO, once a pouch with a strip is opened, the test must be used right away. The active ingredients of the test are moisture-sensitive.

11. How long can the urine sample be stored before testing?

Urine sample can be stored in the refrigerator from 36 to 46 °F (2-8 °C) for up to 48 hours or frozen at 32 °F (0 °C) before testing. However, it is strongly recommended to test the sample as soon as possible after collection.

12. What is the shelf-life of the test?

The shelf-life of the test is 24 months. Each pouch has its due date printed on it; therefore, you will know exactly for how long it is usable. If you receive a package with less than 6 months of shelf-life remaining, we will replace this package free of charge. DO NOT use the test after the expiry date shown on the pouch.

13. Why am I getting both positive and negative results within a short time?

In some cases one can observe contradicting test results within a short time (even within the same day). This usually means that the concentration of THC metabolites in urine is around 50 ng/ml, which is a detection level of these test strips (see FAQ #7).

14. How does the drinking of water and other fluids influence test results?

Excessive drinking of water and other fluids before taking the test will dilute the urine, and the results will be not reliable. Therefore, it is recommended to take the test first thing in the morning before consuming any food or fluids.

15. I have used CBD products. Will my test result be positive for THC?

The test is designed to detect THC metabolites only, therefore, it will not detect CBD. However, if your CBD product contains THC, test results might be positive (it depends on the amount of THC in your CBD product).

LIMITATIONS

- DO NOT use this device to test anything but human urine.
- Bleach or alum in urine samples may produce incorrect results. If contamination is suspected, repeat the test with another urine sample.

RESOURCES

You may contact the following organizations or your health care provider for additional information and counseling regarding substance abuse prevention and treatment:

- The Center for Substance Abuse Treatment (CSAT)
1-877-SAMHSA-7 / www.samhsa.gov
- The National Council on Alcoholism and Drug Dependence (NCADD)
1-800-NCA-CALL / www.ncadd.org

CONFIRMATORY TESTING

For confirmation, preliminary urine should be sent out for confirmatory testing. GC/MS is considered the gold standard in laboratory testing for most drugs.

To purchase a lab confirmation test, please contact Phamatech's Laboratories and Diagnostics Customer Service Department at 1-877-466-3837 or visit www.phamatech.com.

Prepare the following materials that may be used to send the urine sample to the laboratory for confirmatory testing:

- Mailing box;
- Plastic bag.

Take the following steps:

Step 1: Collect a urine sample in a clean and dry container and carefully pour the urine sample into the labeled vial. Fill the vial to about two-thirds (2/3) full and tightly close the cap.

Step 2: Mark the drug that was preliminarily detected on the vial label.

Step 3: Place the labeled vial with the urine test in a plastic bag and seal the plastic bag.

Step 4: Place the plastic bag with the urine container in a mailing box and send it to Phamatech's Laboratories and Diagnostics.

REFERENCES

1. <https://store.samhsa.gov/sites/default/files/d7/priv/sma12-4668.pdf> (p. 58)
2. <https://academic.oup.com/jat/article/38/7/387/2798054>





Distributed by:

Lendas, UAB
369 Lexington Avenue, Suite 361
New York, NY 10017, USA
www.exploroproducts.com

 For *in vitro* diagnostic use only
Catalog number: THC50NGML
Version: THCUS-2025-1
Effective date: 20-10-2025

Exploro® Customer Service:

Toll Free Number: 1 (800) 305-5614
hello@exploroproducts.com

-  Do not reuse
-  Avoid sunshine
-  Temperature limitation
39-86 °F (4-30 °C)
-  Consult instructions for use

**24/7
Support**



exploroproducts.com/support



365-DAY MONEY-BACK GUARANTEE:

We are confident about our product performance, but if it has not met your expectations, we will refund you with all the related expenses (including the cost of shipping) within 365 days from your purchase.